

PCB.WELDING DRAWING (TOLERANCE:±0.05)

Main technical performance	
Rated electrical load	DC 24V 8A
Contact resistance	≤0.03Ω
Insulation resistance	≥100MΩ DC250V
Pressure resistance	AC 500V 1min
Insertion force	3-30N
Operating temperature range	-40C°~+85C°
service life	5000cycles

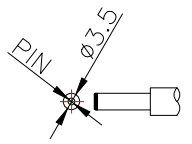

RECOMMEND PULG

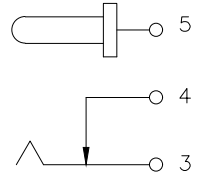

SCHEMATIC

5	圓針	1	黃銅棒	鍍銀
4	蓋片	1	H62黃銅帶(Y)	鍍銀
3	簧片	1	磷銅帶	銅鍍
2	屏蔽罩	1	H62黃銅帶(Y)	黑
1	底座	1	PPA	黑
序號	名稱	數量	材料	備註

MANUFACTURE DWG		东莞市讯普电子科技有限公司 DongGuan XunPu Electronics Co.,Ltd	
UNLESS OTHERWISE SPECIFIED TOLERANCES		TITLE: DC SOCKET	
DECIMALS:		PAR DC-091-A165	
ANGLES:		DWN	
X.X±0.30	X.*±5°	CHKD	
X.XX±0.25	X.X*±1°	APVD	
X.XXX±0.15		SCALE N:A	
CUSTOMER COPY		UNIT:MM	REV:A
		SIZE:A4	SHEET:1F1