

-, MATERIAL:

- 1. Insulator: PBT+30% Glass Fiber
- 2. Contact: Brass
- 3. Contact Plated: Gold Flash over Tin Or Gold Plated Or Tin Plated
- 4. Shell: Steel, Nickel Plated

=, SPECIFICATION:

- 1. Current Rating: 3 AMPS
- 2. Insulation Resistance: 100MΩ MIN. At 500VDC
- 3. Dielectric Strength: 500V for One minute
- 4. Operation Temperature: -55° C ~ +105° C.

*【胶芯颜色、防火要求、环保要求及电镀规格 依据客户实际订单要求为准】

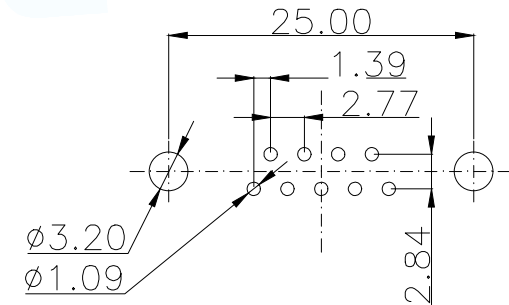

RECOMMEND PCB LAYOUT (T=1.6)
PCB TOLERANCE: ±0.05

MANUFACTURE DWG		 东莞市讯普电子科技有限公司 DongGuan XunPu Electronics Co.,Ltd	
UNLESS OTHERWISE SPECIFIED TOLERANCES		TITLE: DB9M 铆合	
		PAR	D-SUB-DB-9PHM-CW
DECIMALS:	ANGLES:	DWN	
X.X±0.30	X.*±5°	CHKD	
X.XX±0.25	X.X*±2°	APVD	
X.XXX±0.15	X.XX*±1°	SCALE N:A	UNIT:MM
CUSTOMER COPY		SIZE:A4	SHEET:1F1
			REV:A