

焊脚尺寸以顺畅过孔规为准

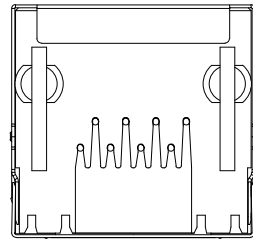
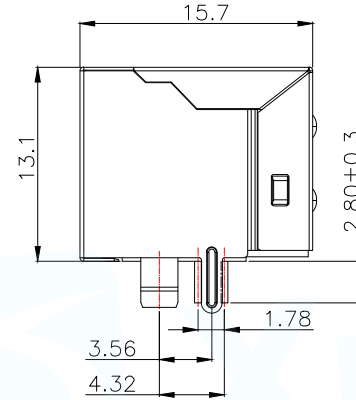
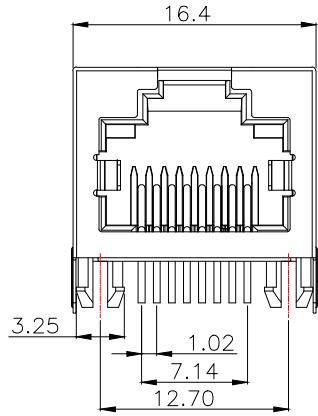

PART NUMBER DESCRIPTION:

RJ45-202-005-XX

流水码

- 01:2.8脚GF PA46黑 盘装
- 02:2.8脚GF PBT黑 盘装
- 03:2.8脚GF PBT黄 盘装

NOTES

MATERIAL

- 1.HOUSING MATERIAL: GLASS FILLED POLYESTER UL94V-0.
- 2.CONTACT MATERIAL: PHOSPHOR BRONZE  $\phi 0.46\text{mm}$ .
- 3.PLATING: SELECT GOLD PLATING OVER NICKEL 50 $\mu$ .
- 4.SHIELD: BRASS T0.20mm 40 $\mu$  NICKEL PLATED.

ELECTRICAL

- 1.VOLTAGE RATING: 125 VAC RMS.
- 2.CURRENT RATING: 1.5 AMP.
- 3.CONTACT RESISTANCE: 40 MILLIOHMS MAX.
- 4.INSULATION RESISTANCE: 500 MEGOHMS MIN @ 100V DC .
- 5.DIELECTRIC DIELECTRIC RESISTANCE: 500V DC RMS 50Hz. 1MIN.

MECHANICAL

- 1.DURRABILITY: 750 CYCLES MIN.
- 2.MATING/UNMATING FORC: 2.24 KG.F MAX.

ENVIRONMENTAL:

- 1.STORAGE: -40 $^{\circ}$ ~+85 $^{\circ}$ .
- 2.OPERATION: -40 $^{\circ}$ ~+85 $^{\circ}$ .

8	—
7	—
6	RX-
5	—
4	—
3	RX+
2	TX-
1	TX+
PIN	说明

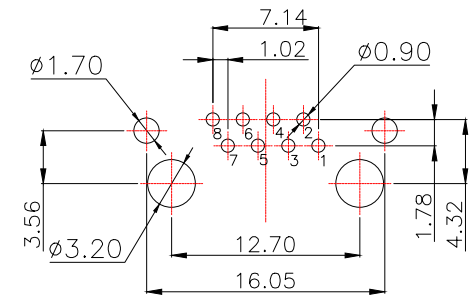

PCBLAYOUT T=1.6mm  
TOL:±0.05

MANUFACTURE DWG		东莞市讯普电子科技有限公司 DongGuan XunPu Electronics Co.,Ltd	
UNLESS OTHERWISE SPECIFIED TOLERANCES			TITLE: RJ45 56 B型无源无灯DIP
			PAR RJ45-202-005-01
DECIMALS:	ANGLES:		DWN
.X:±0.35	X':±3'		CHKD
.XX:±0.25	.X':±2'	APVD	
.XXX:±0.15	.XX':±1'	CUSTOMER COPY	SCALE:1:1 UNIT:MM
		SIZE:A4	SHEET:1F1
			REV:A