

|      |              |      |         |
|------|--------------|------|---------|
| 12   | 13           | 14   | 15      |
| MAPX | MODIFICATION | DATE | DRAW    |
|      |              |      | APPROVE |

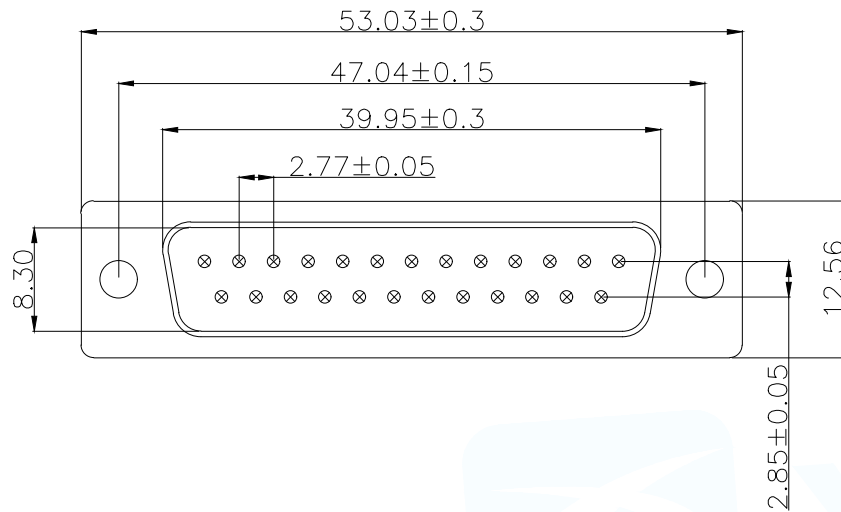

-、 MATERIAL:

1. Insulator: PBT+30% Glass Fiber
2. Contact: Brass
3. Contact Plated: Gold Flash over Tin Or Gold Plated Or Tin Plated
4. Shell: Steel, Nickel Plated

=、 SPECIFICATION:

1. Current Rating: 3 AMPS
2. Insulation Resistance: 100M $\Omega$  MIN. At 500VDC
3. Dielectric Strength: 500V for One minute
4. Operation Temperature:  $-55^{\circ}$  C ~  $+105^{\circ}$  C.

✱【胶芯颜色、防火要求、环保要求及电镀规格 依据客户实际订单要求为准】

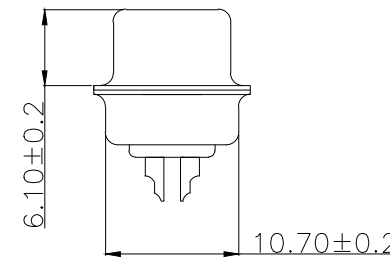
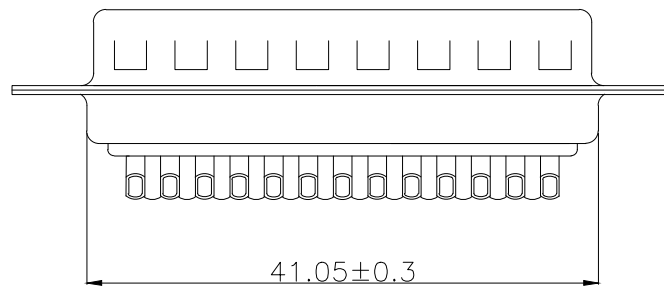

|                                       |                                    |   |                       |
|---------------------------------------|------------------------------------|---|-----------------------|
| MANUFACTURE DWG                       |                                    |  东莞市讯普电子科技有限公司<br>DongGuan XunPu Electronics Co.,Ltd |                       |
| UNLESS OTHERWISE SPECIFIED TOLERANCES |                                    |    | TITLE:<br>DB25M传统胶壳   |
|                                       |                                    |   | PAR D-SUB-DB-25PHG-BW |
| DECIMALS:                             | ANGLES:                            |   | DWN                   |
| X.X $\pm$ 0.30                        | X. $^{\circ}$ $\pm$ 5 $^{\circ}$   |   | CHKD                  |
| X.XX $\pm$ 0.25                       | X.X $^{\circ}$ $\pm$ 2 $^{\circ}$  | APVD  |                       |
| X.XXX $\pm$ 0.15                      | X.XX $^{\circ}$ $\pm$ 1 $^{\circ}$ | CUSTOMER COPY   | SCALE N:A UNIT:MM     |
|                                       |                                    | SIZE:A4   | UNIT:MM               |
|                                       |                                    | SHEET:1F1   | REV:A                 |