

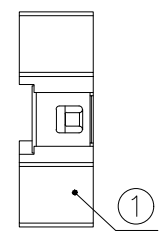

12	13	14	15
MAPX	MODIFICATION	DATE	APPROVE

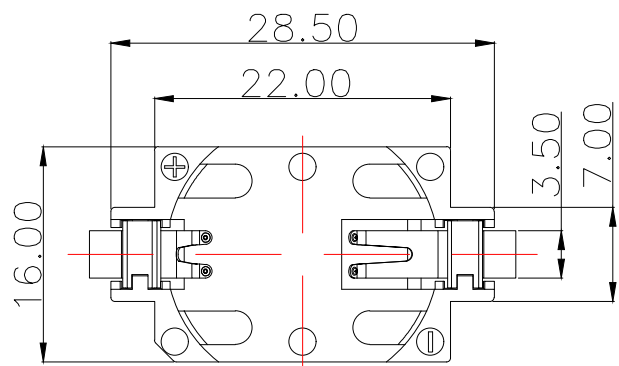

NOTE:

- 1.MATERIAL:
  - a.HOUSING:LCP UL94V-0
  - b.CONTACT:PHOSPHOR BRONZE  
(SURFACE PLATING:Sn100u"-120u")
- 2.ELECTRIC:
  - a.CONTACT RESISTANCE: 50 MILLIOHMS  
MAX
  - b.INSULATION RESISTANCE: 100 MEGA  
OHMS MIN
  - c.DIELECTNIC VOLTAGE: 500V AC ONE SEC  
LEVEL
  - d.OPERATING TEMPERATURE: -25°C~  
+85°C

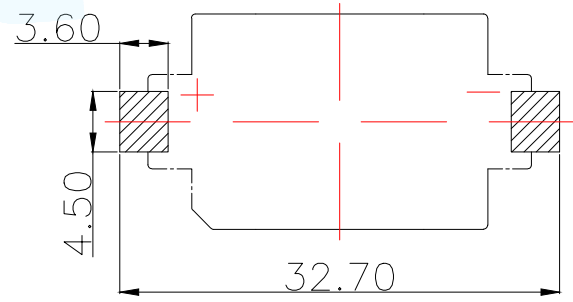
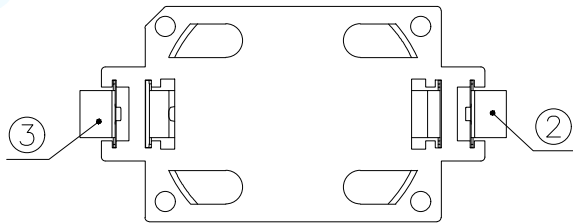
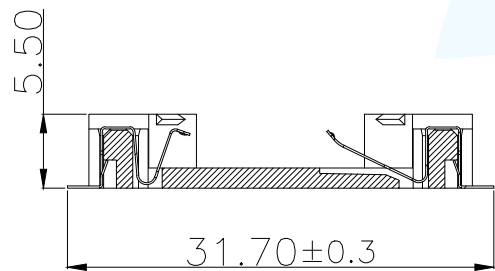

PCB Layout Diagram  
Top View

3	TERMINAL(-)	1	PHOSPHOR BRONZE, T=0.15mm	Sn Plating
2	TERMINAL(+)	1	PHOSPHOR BRONZE, T=0.15mm	Sn Plating
1	HOUSING	1	LCP	WHITE
NO.	PART NAME	Q'TY	MATERIAL	PLATING & COLOR

MANUFACTURE DWG		东莞市讯普电子科技有限公司 DongGuan XunPu Electronics Co.,Ltd		
UNLESS OTHERWISE SPECIFIED TOLERANCES			TITLE: Sn SMT	
DECIMALS:	ANGLES:		PAR	BS-0601-SK-4W
X.X±0.30	X.*±5°		DWN	
X.XX±0.25	X.X*±1°		CHKD	
X.XXX±0.15		APVD		
CUSTOMER COPY		SCALE N:A	UNIT:MM	
		SIZE:A4	SHEET:1F1	
			REV:A	



12	13	14	15
MAPX	MODIFICATION	DATE	DRAW

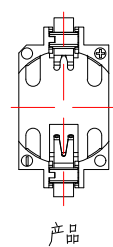

产品

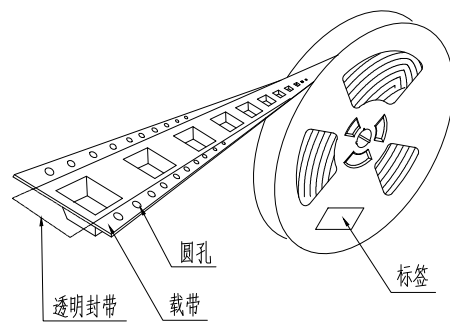

透明封带

载带

圆孔

标签

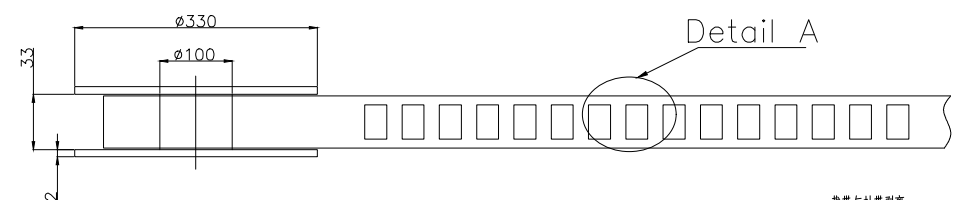

Detail A

载带与封带剥离  
 剥离角度: 165° - 180°  
 剥离速度: 0.1 - 1.0N  
 (300mm/min)

余留封带长: 300 MIN

剥离方向

出料方向

10空穴

共封装 500 只产品

300MIN

末端留空穴载带

前端留空穴载带

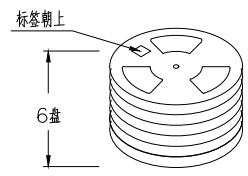
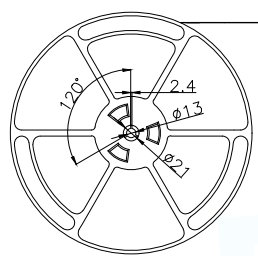

标签朝上

6盘

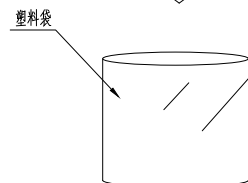

塑料袋

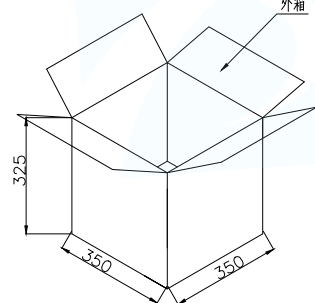

外箱

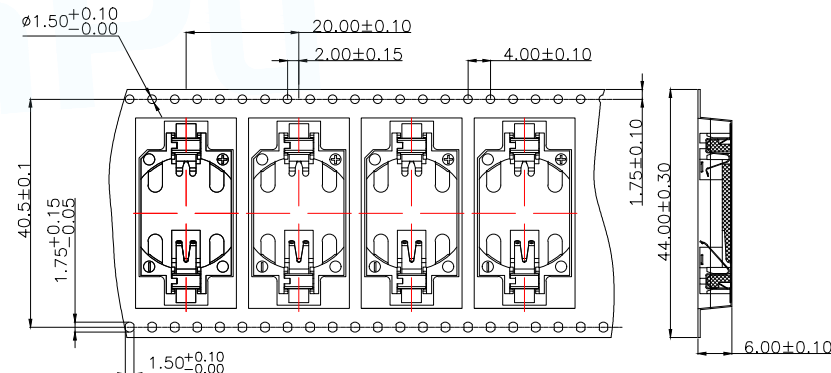
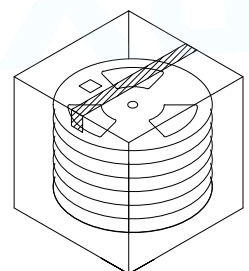

Detail A

技术要求:

1. 圆孔十个孔距离累计允许公差为±0.2mm
2. 带长250mm内容许弯曲度1mm
3. 材料厚度以在载带边缘测量为准
4. 所有尺寸定义依循EIA-481-C系准则定义之
5. 材料: 黑色PS T=0.35mm
6. 所有卷轮为灰蓝挖空旋转塑胶卷轮
7. 整模成型长度: 10.5M,
8. 非指明公差范围为: ±0.1mm; 超过250mm不计算累计误差
9. 型腔外形凡未标明处倒角R为0.2-0.3; 拔模斜度未标注的为3° 以下

包装信息:

1. 每卷盘装产品 500 只, 卷盘外侧贴相关标签;
2. 每 6 卷盘放在一个塑料袋中;
3. 每外箱装 6 盘, 产品总数: 3000 只;
4. 外箱上下用胶纸封成"工"字;
5. 净重: 4.56 KG, 毛重: 7.5 KG.

MANUFACTURE DWG			
UNLESS OTHERWISE SPECIFIED TOLERANCES		TITLE: Sn SMT 载带	
DECIMALS:			PAR
ANGLES:			DWN
X.X±0.30	X.*±5°		CHKD
X.XX±0.25	X.X*±1°		APVD
X.XXX±0.15		CUSTOMER COPY	SCALE N/A
			UNIT:MM
			SIZE:A4
			SHEET:1F1
			REV:A